

STATE OF NORTH CAROLINA
DIVISION OF HIGHWAYS

SURRY COUNTY

TYPE OF WORK: FULL DEPTH RECLAMATION
SECONDARY ROUTE

2022

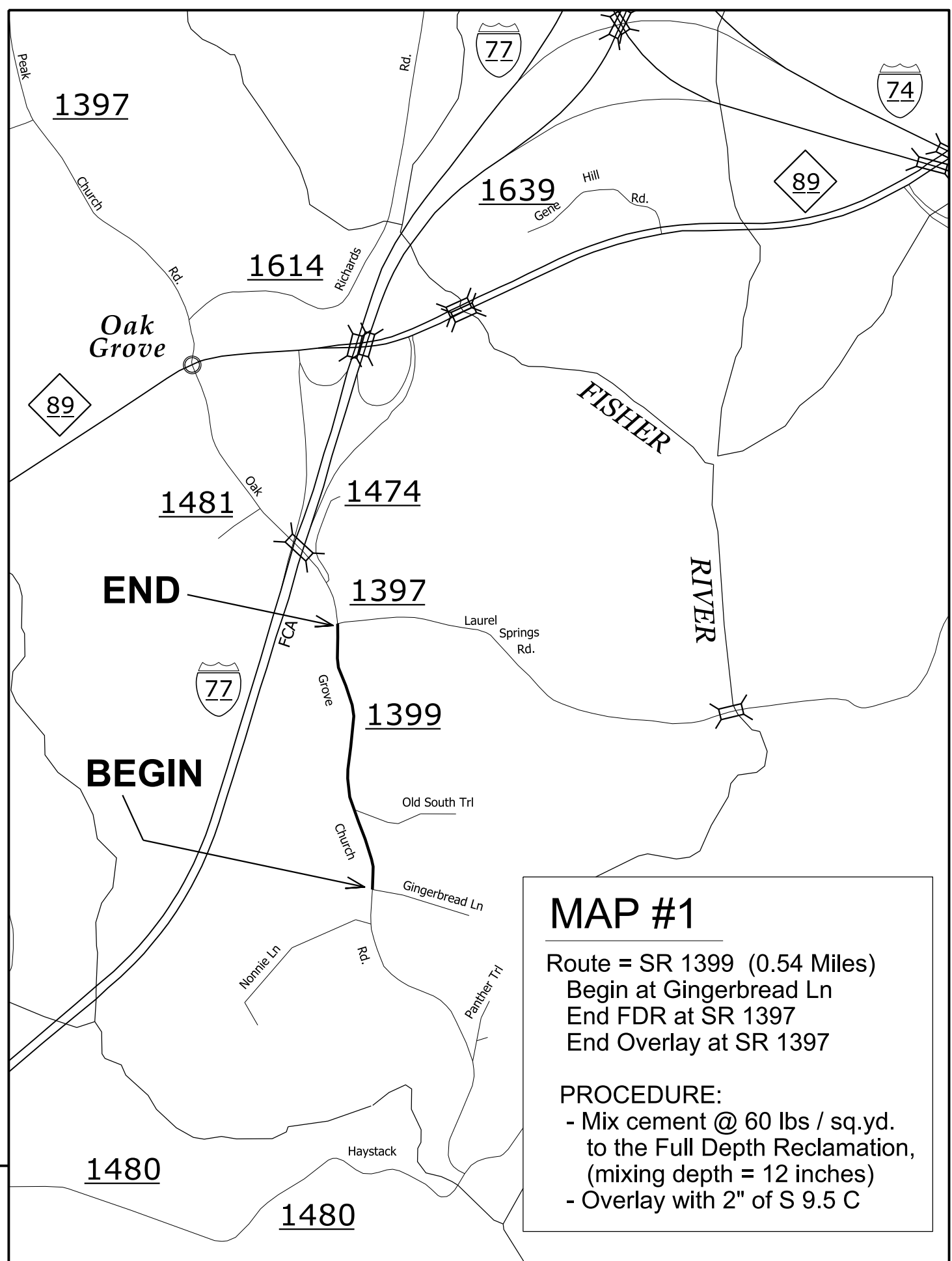
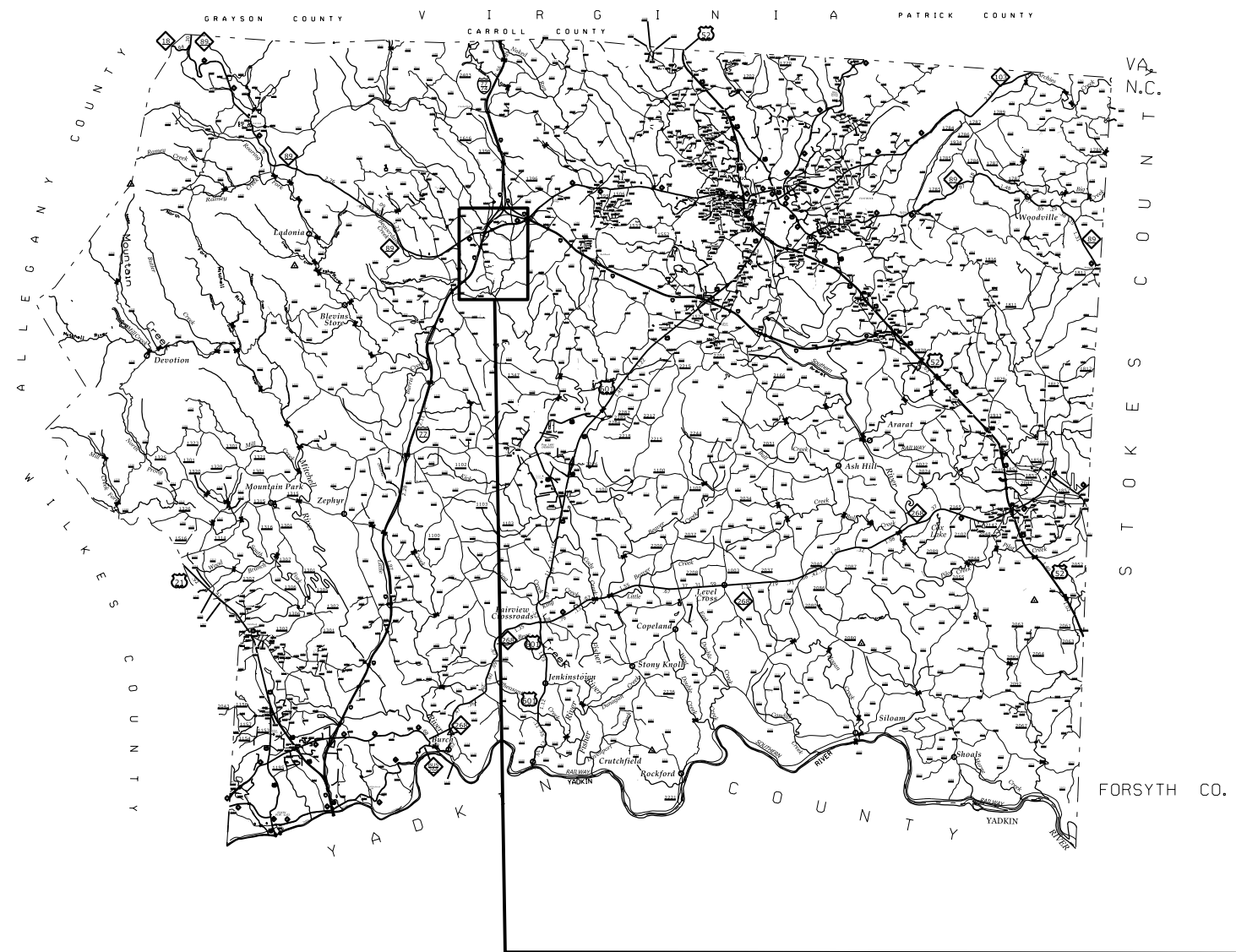

MAP #1

Route = SR 1399 (0.54 Miles)
 Begin at Gingerbread Ln
 End FDR at SR 1397
 End Overlay at SR 1397

PROCEDURE:

- Mix cement @ 60 lbs / sq.yd. to the Full Depth Reclamation, (mixing depth = 12 inches)
- Overlay with 2" of S 9.5 C

STATE OF NORTH CAROLINA
DIVISION OF HIGHWAYS

SURRY COUNTY

TYPE OF WORK: FULL DEPTH RECLAMATION
SECONDARY ROUTE

2022

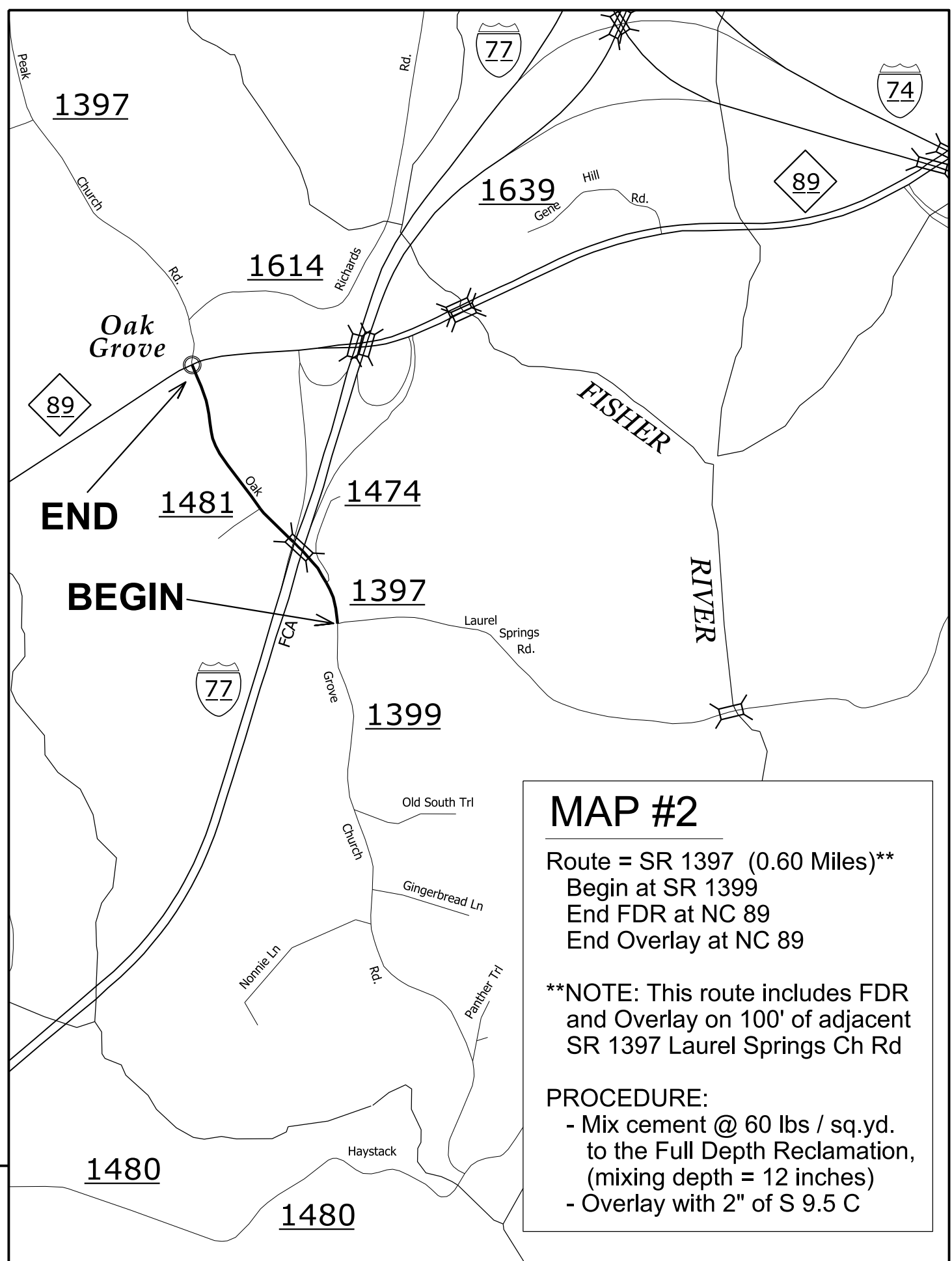
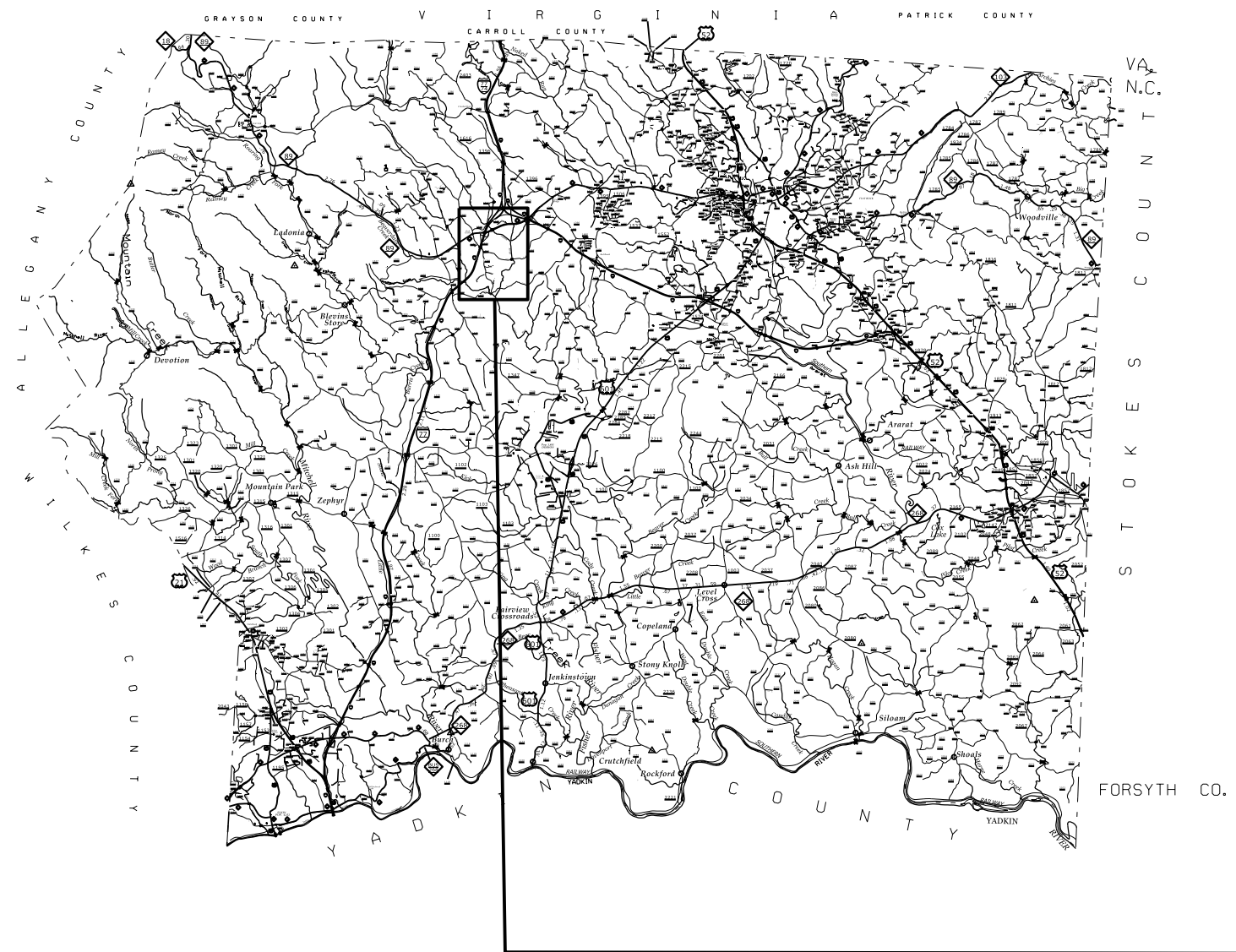

MAP #2

Route = SR 1397 (0.60 Miles)**
 Begin at SR 1399
 End FDR at NC 89
 End Overlay at NC 89

**NOTE: This route includes FDR and Overlay on 100' of adjacent SR 1397 Laurel Springs Ch Rd

PROCEDURE:

- Mix cement @ 60 lbs / sq.yd. to the Full Depth Reclamation, (mixing depth = 12 inches)
- Overlay with 2" of S 9.5 C

PAVEMENT SCHEDULE	
C1	PROP. APPROX. 2" ASPHALT CONCRETE SURFACE COURSE, TYPE S9.5C AT AN AVERAGE RATE OF 224 LBS. PER SQ. YD.
T	SHOULDER RECONSTRUCTION
U	EXISTING PAVEMENT
V1	INCIDENTAL MILLING - 0" TO 2" (See Detail Below)
Z	FULL DEPTH RECLAMATION - 12" ADD CEMENT AT RATE OF 60 LBS. per SQ. YD.

PAVEMENT EDGE SLOPES ARE 1:1 UNLESS OTHERWISE INDICATED

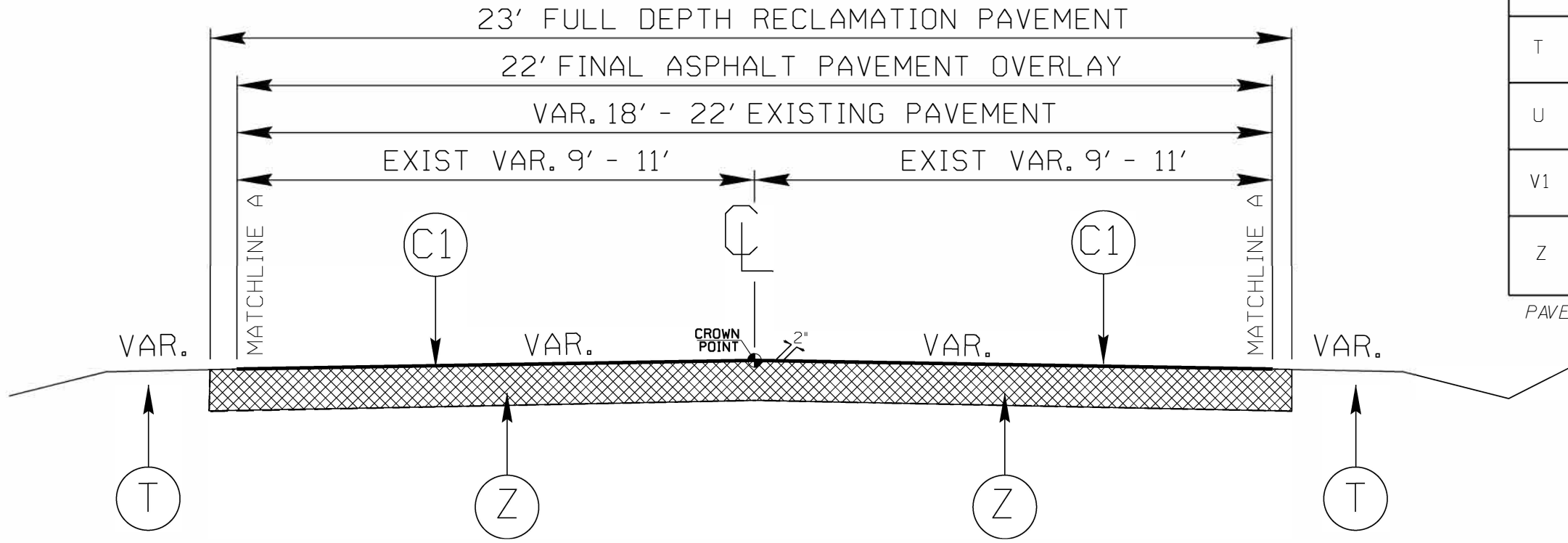

TYPICAL SECTION NO. 1

MAP 1 - SR 1399 OAK GROVE CH RD FROM GINGERBREAD LN TO SR 1397
 (NOTE: 2 Drives LT side of SR 1399 will require concrete pavement removal as a result of road widening)

MAP 2 - SR 1397 OAK GROVE CH RD FROM SR 1399 TO NC 89

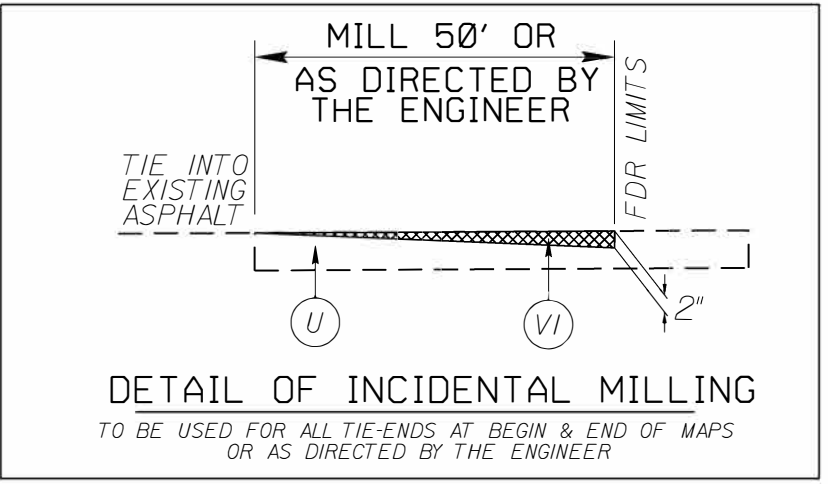

DETAIL OF INCIDENTAL MILLING
 TO BE USED FOR ALL TIE-ENDS AT BEGIN & END OF MAPS
 OR AS DIRECTED BY THE ENGINEER

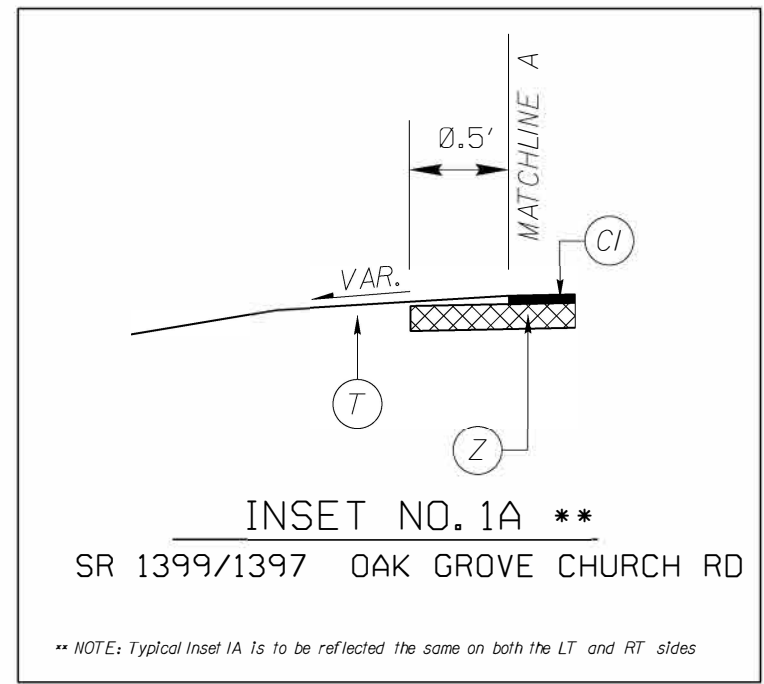

INSET NO. 1A **
 SR 1399/1397 OAK GROVE CHURCH RD

** NOTE: Typical Inset 1A Is to be reflected the same on both the LT and RT sides

SURRY COUNTY 2022 SECONDARY ROAD FULL DEPTH RECLAMATION DIVISION 11		
REVISIONS INIT. DATE		
N.C. DEPARTMENT OF TRANSPORTATION DIVISION OF HIGHWAYS DIVISION ELEVEN		SCALE: N/A DATE: 05/2022 PREPARED BY: D.L. HAGWOOD REVIEWED BY:

PROJECT NO.	SHEET NO.	TOTAL NO.
2022CPT.11.27.20862	1	2

SUMMARY OF QUANTITIES

PROJECT NO	COUNTY	MAP NO	ROUTE	ROUTE NAME	FROM DESCRIPTION	TO DESCRIPTION	MILEPOST FROM	MILEPOST TO	TYP NO	LANE TYPE	LENGTH	WIDTH	0106000000-E	0163000000-E	0241000000-E	1220000000-E	1245000000-E	1330000000-E	1523000000-E	1575000000-E	6084000000-E
													BORROW EXCAVATION	REMOVAL OF EXISTING CONCRETE PAVEMENT	SOIL CEMENT BASE (FULL DEPTH RECLAMATION)	INCIDENTAL STONE BASE	SHOULDER RECONSTRUCTION	INCIDENTAL MILLING	SURFACE COURSE, S9.5C	ASPHALT BINDER FOR PLANT MIX	SEED & MULCHING
											MI	FT	CY	SY	SY	TON	SMI	SY	TON	TON	AC
2022CPT.11.27.20862	Surry	1	SR 1399	Oak Grove Ch Rd	Gingerbread Ln (NS)	SR 1397	0.70	1.24	1	2WU	0.54	18-22	108	50	7,286	50	1.08		820	55	0.39
2022CPT.11.27.20862	Surry	2	SR 1397	Oak Grove Ch Rd	SR 1399	NC 89	2.78	3.38	1	2WU	0.60	18-22	120		8,096	50	1.20	175	911	61	0.44
TOTAL FOR PROJ NO. 2022CPT.11.27.20862													228	50	15,382	100	2.28	175	1,730	116	0.83

PROJECT NO.	SHEET NO.	TOTAL NO.
2022CPT.11.27.20862	2	2

THERMOPLASTIC AND PAINT QUANTITIES

PROJECT NO.	COUNTY	MAP NO.	ROUTE	ROUTE NAME	FROM DESCRIPTION	TO DESCRIPTION	MILE POST FROM	MILE POST TO	TYP NO	LANE TYPE	LENGTH	WIDTH	441300000-E	445700000-N	481000000-E			
													WORK ZONE ADVANCE/ GENERAL WARNING SIGNING	TEMPORARY TRAFFIC CONTROL	4" WHITE PAINT	4" YELLOW PAINT		
												MI	FT	SF	LS	LF	LF	
2022CPT.11.27.20862	Surry	1	SR 1399	Oak Grove Ch Rd	Gingerbread Ln (NS)	SR 1397	0.70	1.24	1	2WU	0.54	18-22	70	1	11,405	11,405		
2022CPT.11.27.20862	Surry	2	SR 1397	Oak Grove Ch Rd	SR 1399	NC 89	2.78	3.38	1	2WU	0.60	18-22	78		12,672	12,672		
TOTAL FOR PROJ NO. 2022CPT.11.27.20862												1.14		148	1	24,077	24,077	48,154

SIGNING FOR RESURFACING PROJECTS

LEGEND
 ┆ STATIONARY SIGN
 ← DIRECTION OF TRAFFIC FLOW

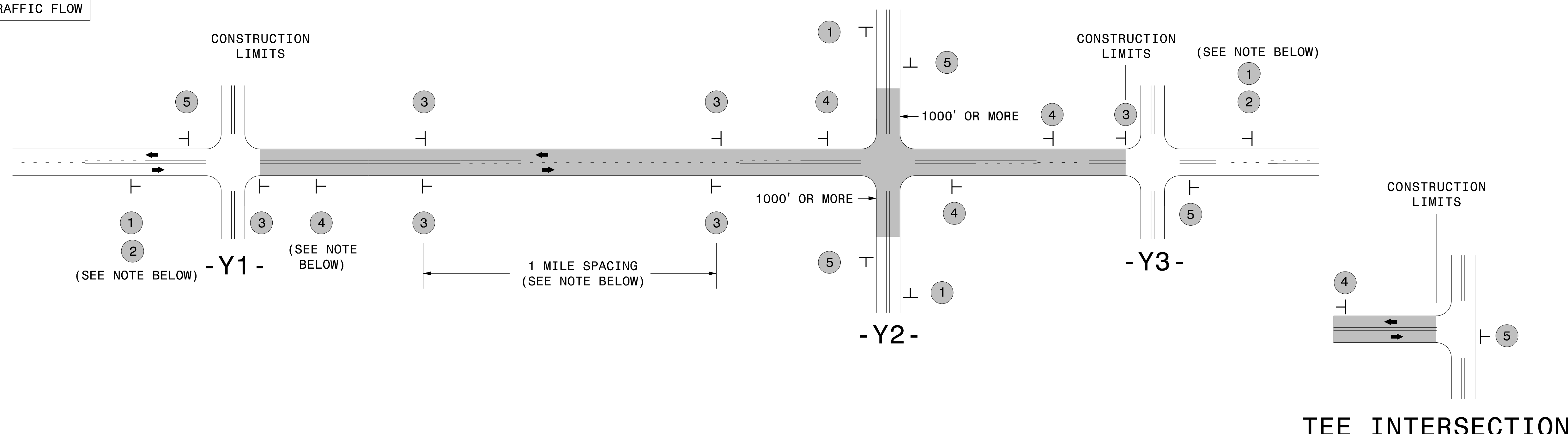

MAINLINE (-L-) SIGNING

-Y- LINE SIGNING

SIGNING NOTES AND PLACEMENT PER DIRECTION	1		PLACE 1000' PRIOR TO BEGINNING OF CONSTRUCTION LIMITS. ONLY USED ON -Y- LINES IF RESURFACING LIMITS EXTEND 1000' ALONG -Y- LINE.	<p>NO REQUIRED STATIONARY SIGNING FOR THE FOLLOWING -Y- LINE CONDITIONS:</p> <ol style="list-style-type: none"> 1) LESS THAN 1000' OF RESURFACING ALONG -Y- LINE 2) SUBDIVISION ROADS 3) DEAD END ROADS <p>WHEN PAVING/CONSTRUCTION ACTIVITIES PROCEED ACROSS AN UNSIGNED -Y- LINE, PORTABLE ADVANCE WARNING SIGNS SHALL BE USED ALONG THE -Y- LINE AS SHOWN BELOW. REMOVE UPON COMPLETION OF WORK.</p> <div style="display: flex; justify-content: space-around;"> <div style="text-align: center;"> PLACED 500' IN ADVANCE OF FLAGGER. </div> <div style="text-align: center;"> PLACED 250' IN ADVANCE OF FLAGGER. </div> </div>
	2		#2 SIGN ONLY USED WHEN CONSTRUCTION LIMITS ARE 2 OR MORE MILES IN LENGTH. ROUND UP TO NEXT WHOLE NUMBER. (NO FRACTIONAL OR DECIMAL NUMBERS)	
	3		- PLACE INITIALLY AT THE CONSTRUCTION LIMITS AND SPACE 1 MILE APART THEREAFTER. - AT TEE INTERSECTIONS INSTALL INITIALLY 1/2 MILE FROM INTERSECTION AND SPACE 1 MILE APART THEREAFTER.	
	4		- THESE ARE FOR -Y- LINES THAT ARE "THROUGH" ROADWAYS. - DEAD END AND SUBDIVISION ROADS ARE NOT "THROUGH" ROADWAYS. - INSTALL 500' +/- FROM EACH -Y- LINE APPROACH AS SHOWN ABOVE. - FOR MULTIPLE -Y- LINES THAT ARE SEPARATED BY 0.25 MILES OR LESS, TREAT AS A SINGLE UNIT AND INSTALL WITHIN 500' OF EACH APPROACH. - A MAXIMUM OF 2 SIGN SETS PER MILE. DO NOT INSTALL WHEN -Y- LINES ARE WITHIN 0.5 MILES FROM "END ROAD WORK" SIGN. - FOR TEE INTERSECTIONS, INSTALL WITHIN 500' +/- OF THE INTERSECTION ALONG -L- LINE.	
	5		PLACE 500' FOLLOWING THE END OF CONSTRUCTION LIMITS OR AS SHOWN WHEN WORK ENDS AT A 3-WAY TEE INTERSECTION.	

THE ABOVE SIGNS ARE ALL THAT ARE REQUIRED FOR A CONTRACTOR TO BEGIN A RESURFACING CONTRACT. ANY ADDITIONAL SIGNS REQUESTED BY NCDOT DIVISIONS SHALL BE INSTALLED WITHIN 7 BUSINESS DAYS OF THE START OF CONTRACT WORK.

MAPS LESS THAN 2 MILES

FOR RESURFACING MAPS WITH CONSTRUCTION LIMITS LESS THAN 2 MILES IN LENGTH, NO STATIONARY SIGNS ARE REQUIRED. USE PORTABLE "ROAD UNDER CONSTRUCTION" OR "ROAD WORK AHEAD" SIGNS IN LIEU OF STATIONARY ADVANCE WARNINGS SIGNS.

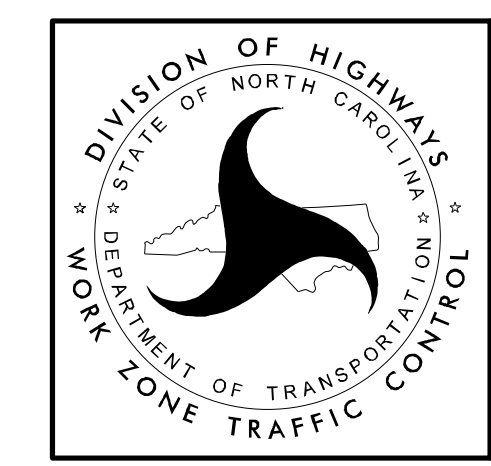

ADVANCE WARNING SIGNS FOR RURAL AND SUBURBAN 2-LANE ROADWAY RESURFACING